

## VARIABLE AREA FLOW METER

### Z-500 SERIES PLASTIC ROTAMETER

Flow Measurement  
Measurement & Control



#### DESCRIPTION

The Z-500 series rotameter apply the principle of variable area flowmeter where the flow raises a float in a tapered tube expanding the cross section of fluid passage. The float moves up proportionally to the flow rate.

The rotameter comes with direct reading dual-scale in GPM and LPM of water at 20°C. Body made of Polycarbonate with stainless steel guiding rod, connector in PVC and float material in ABS or SS316 as option.

It must be installed vertically with rising fluid, from bottom to top. It is recommended to have a length upstream of 10x DN and downstream of 5x DN.

#### TECHNICAL FEATURES

#### FEATURES

- ✓ Low cost of double scale meter
- ✓ Direct reading scale (GPM-LPM)
- ✓ Union type in line fittings provide ease of installation and maintenance
- ✓ High/low flow alarm switch (reed type) is rated at 24VDC
- ✓ Working pressure limit 0.6MPa
- ✓ Working temperature limit 60°C
- ✓ Accuracy:  $\pm 5\%$

<b>Medium</b>	Liquid at water density
<b>Float Material</b>	ABS or SS316
<b>Guiding Rod Material</b>	Stainless steel
<b>Tube Material</b>	Polycarbonate (PC)
<b>Connection Material</b>	PVC
<b>O-ring</b>	Viton
<b>Pressure</b>	Max 6 Bar
<b>Temperature</b>	Max 60°C
<b>Accuracy</b>	$\pm 5\%$ M.V
<b>Mounting Position</b>	Vertical, flow from bottom to top
<b>Connection</b>	Glue ends (BS standard) Female/Male thread end (BSP / NPT) Elbow ends (BSP / NPT)
<b>Alarm Contact (optional)</b>	High / Low limit (DN25 to DN50 only) Reed type 24V DC



**FLOW / SPECIFICATIONS**

Model	Measuring Range		Glue (mm)	Male Thread	Female Thread	Elbow (Nylon)
	GPM	LPM				
Z-5008	0.1 - 1	0.5 - 4	Ø20	1/2" BSP 1/2" NPT	/	1/2" BSP 1/2" NPT
	0.2 - 2	1 - 7				
	0.5 - 5	1.8 - 18				
Z-5008C	0.1 - 1	0.5 - 4	Ø20	1/2" NPT 3/4" NPT	/	1/2" BSP 1/2" NPT
	0.2 - 2	1 - 7				
	0.5 - 5	1.8 - 18				
Z-5015	0.25 - 2.5	1 - 10	Ø20	1/2" NPT 3/4" NPT	/	1/2" BSP 1/2" NPT
	0.5 - 5	1.8 - 18				
	0.8 - 8	3 - 30				
Z-5025	0.8 - 8	3 - 30	Ø32	3/4" NPT	3/4" BSP 3/4" NPT	3/4" BSP 3/4" NPT
	1 - 10	4 - 40				
Z-5032	1.2 - 12	5 - 50	Ø40	1" NPT	1" BSP 1" NPT	1" BSP 1" NPT
	2 - 20	8 - 80				
	2.5 - 25	10 - 100				
Z-5050	2.5 - 25	10 - 100	Ø63	2" NPT	2" BSP 2" NPT	2" BSP 2" NPT
	5 - 45	20 - 180				
	7 - 70	25 - 250				
Z-5065	25 - 110	80 - 400	Ø75	/	2 1/2" NPT	/
	40 - 160	150 - 650				
	50 - 250	200 - 1000				

\*Z-5008 / Z-5008C / Z-5015 / Z-5065 without alarm switch



**DRAWING / DIMENSION**

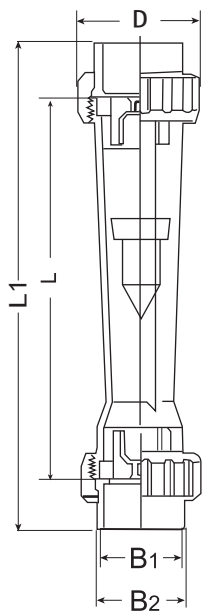

Glue Type

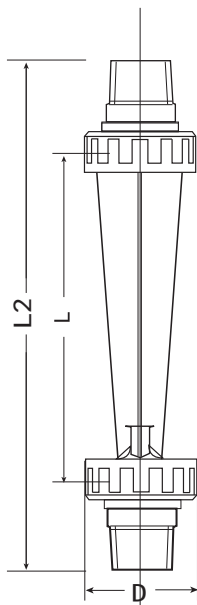

Male Thread

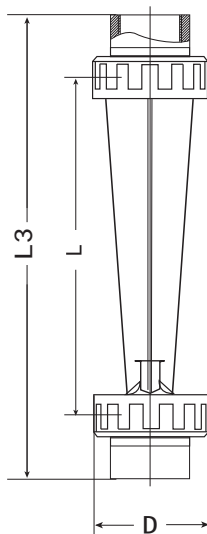

Female Thread

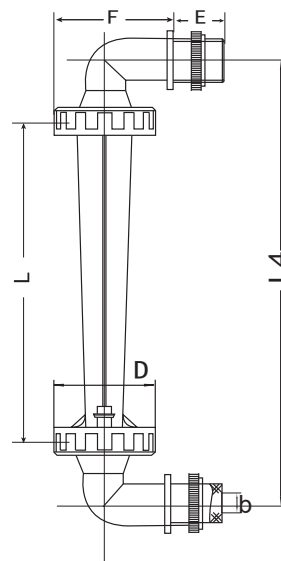

Elbow Type

Model	L	D	Glue Type			Male	Female	Elbow			
			L1	B1	B2	L2	L3	L4	E	F	b
Z-5008	99	42	146	20	26	170	/	153	27	55	Ø12
Z-5008C	160	51	210	20	26	230	209	235	27	55	Ø13
Z-5015	135	51	180	20	26	210	183	205	27	55	Ø13
Z-5025	170	59	226	32	39	253	228	267	35	83	Ø20
Z-5032	223	72	287	40	49	317	287	330	40	95	Ø26
Z-5050	290	100	375	63	73	400	370	440	40	120	Ø45
Z-5065	325	120	420	75	89	/	423	/	/	/	/

\*Unit in mm

