

Low flow-rate flowmeters 1900/1901/1903



- Direct reading of low flow-rates
- 3 models - C to C (A): 100, 170 or 320 mm
- ATEX version on request
- Pressure limit: 16 bar
- Temperature: -20 ... +100 °C
- Borosilicate glass tube
- Protection screen: PMMA (Ex version: PCC)
- Sealing: rubber, FPM, EPDM
- Fittings: NPT-F or BSP-F size 1/4"
- **OPTIONS:**
Pressure regulator
Inductive contacts

APPLICATIONS

Direct reading flow indicators with adjustment valve for low flow rates of liquids or gases (valve on request for models 1901 and 1903)

PRINCIPLE

Variable area flowmeters: the diver ("float") moves inside a conical measuring tube.

LIMIT SWITCHES

Inductive type: Only for metal float; Cable output; Supplied with 1 m long cable
Add an amplifier relay providing an appropriate power supply to the inductive contact

For contact in ATEX version: the contact must be connected via an Intrinsic Safety relay (RDN11, data-sheet 250-03)

CODE NUMBERS AND REFERENCES

Code	Type	Materials (body, valve)	C to C A [mm]	Height scale	Length B [mm]	Accuracy
790 101	1900	PVC	100	63	128	±5 %
790 200	1900	AISI 316 L	100	63	128	
790 300	1901	AISI 316 L	170	90	198	±3 %
790 400	1903	AISI 316 L	320	240	348	

OPTIONS, ACCESSORIES

Code	Description
790 035	Inductive contact, monostable
790 037	Inductive contact, bistable
251 011	Intrinsic safety relay RDN 11 (NAMUR)
790 051	Protection screen for 1901 model without contact
790 053	Protection screen for 1903 model without contact
790 205	Needle valve for stainless steel models with range ≤ 60 NI/h

BAMO INTERNATIONAL

22, Rue de la Voie des Bans · Z.I. de la gare · 95100 ARGENTEUIL

Tel +33 (0)1 30 25 83 20 Web www.bamo.eu

Fax +33 (0)1 34 10 16 05 E-mail export@bamo.fr

Low flow-rate flowmeters
1900/1901/1903

15-02-2021

D-790.01-EN-AB

DEB

790-01 /1

1900; 1901; 1903 valve/ISI 316 L body and

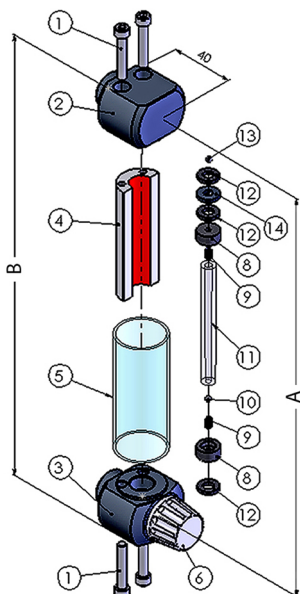

1900 - PVC body and valve

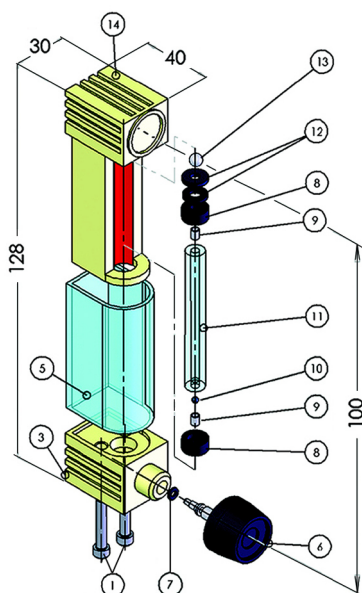

- 1) Screw
- 2) Top armature
- 3) Bottom armature/ needle valve
- 4) Rear frame
- 5) PMMA Protection screen
- 6) Valve needle
- 7) O-ring seal
- 8) Reading tube seal
- 9) Spring
- 10) Float
- 11) Reading tube
- 12) Washer
- 13) On request: Check ball
- 14) PVC flowmeter armature

TECHNICAL FEATURES

1900 model		
Float material	AIR scale: 20 °C & 1 bar ABS	Water scale at 20 °C
Glass	1...10 NI/h	-
AISI 316 L	2,5...25 NI/h	-
Glass	3...30 NI/h	-
AISI 316 L	5...60 NI/h	0,025...0,85 l/h
Glass	10...100 NI/h	0,2...2 l/h
AISI 316 L	20...190 NI/h	0,5...5 l/h
Glass	20...250 NI/h	0,25...6 l/h
AISI 316 L	40...460 NI/h	1...13 l/h
Glass	50...600 NI/h	0,5...15 l/h
AISI 316 L	100...1100 NI/h	3...36 l/h
Tungsten carbide	150...1600 NI/h	5...50 l/h
Glass	250...850 NI/h	4...20 l/h
AISI 316 L	450...1600 NI/h	13...50 l/h
Tungsten carbide	400...2000 NI/h	15...70 l/h

1901 model		
Float material	AIR scale: 20 °C & 1 bar ABS	Water scale at 20 °C
Glass	85...850 NI/h	2...20 l/h
AISI 316 L	160...1600 NI/h	5...50 l/h
Tungsten carbide	200...2000 NI/h	7...70 l/h

1903 model		
Float material	AIR scale: 20 °C & 1 bar ABS	Water scale at 20 °C
Glass	3...60 NI/h	0,07...1 l/h
AISI 316 L	10...115 NI/h	0,2...3 l/h
Glass	4...115 NI/h	0,1...2,5 l/h
AISI 316 L	16...220 NI/h	0,2...6 l/h
Glass	4...190 NI/h	0,05...4 l/h
AISI 316 L	10...340 NI/h	0,1...10 l/h
Glass	20...560 NI/h	0,3...11 l/h
AISI 316 L	40...1000 NI/h	1...30 l/h
Glass	20...600 NI/h	0,5...15 l/h
AISI 316 L	40...1100 NI/h	3...36 l/h
Tungsten carbide	100...1400 NI/h	1...45 l/h
Glass	85...850 NI/h	1,9...19 l/h
AISI 316 L	160...1600 NI/h	5...50 l/h
Tungsten carbide	200...2100 NI/h	7...70 l/h

On request, models 1901 and 1903 can be supplied with a needle valve.

Stainless steel models with measuring ranges ≤ 60 NI/h require the addition of a precision valve.

(Code Nr 790 205)

BAMO INTERNATIONAL

22, Rue de la Voie des Bans · Z.I. de la gare · 95100 ARGENTEUIL
 Tel +33 (0)1 30 25 83 20 Web www.bamo.eu
 Fax +33 (0)1 34 10 16 05 E-mail export@bamo.fr

Low flow-rate flowmeters
1900/1901/1903

15-02-2021

D-790.01-EN-AB

DEB

790-01 /2