

Float level regulator VAFLO



- Autonomous system
- Level controller
- Adjustable height
- Float in Polyester or in PPH

APPLICATIONS

Regulation of water filling level in a tank.

DESCRIPTION

The VAFLO regulates automatically, the high level of water, without power supply.

The system is simply mechanical: When the level rises, the float causes the closure of the water inlet nozzle.

The level adjustment is possible within 120 mm when mounting the system.

TECHNICAL FEATURES

- Adjustable float stroke within 120 mm
- Standard flow rate: 1800 l/h with 1 bar – Pressure limit: 6 bar
On request Q=3600 l/h with 1 bar – Pressure limit: 4 bar

Fittings:

- Or male thread BSP 1/2"
- Or flange ND 15 /PN 10 (for flat gasket)

CODE NUMBERS AND REFERENCES

| Code | Reference | Float | Guiding rod | Body | Seal | Fitting |
|---------|-----------|-----------|--------------|-----------|------|--------------|
| 527 015 | VAFLO 15 | Polyester | AISI 316 L | Hostaform | NBR | 1/2" MG |
| 527 020 | VAFLO 20 | PPH | Hastelloy B2 | PPH | FPM | 1/2" MG |
| 527 025 | VAFLO 25 | PPH | Hastelloy B2 | PPH | FPM | Flange DN 15 |

Note: Fitting and valve are of the same material.

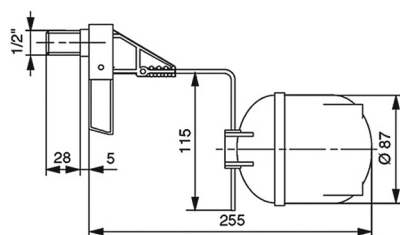

VAFLO 15

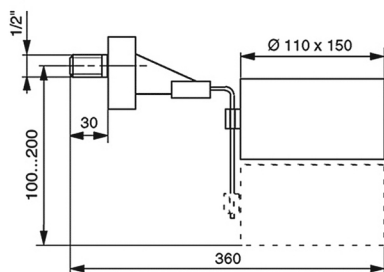

VAFLO 20

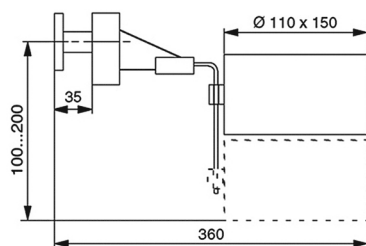

VAFLO 25

BAMO INTERNATIONAL

22, Rue de la Voie des Bans · Z.I. de la gare · 95100 ARGENTEUIL

Tel +33 (0)1 30 25 83 20 Web www.bamo.eu

Fax +33 (0)1 34 10 16 05 E-mail export@bamo.fr

Float level regulator
VAFLO

19-12-2019

D-527.01-EN-AC

NIV

527-01 /1