

Manually operated 2-way ball valves, industrial series VM2V M1

- Secure and lockable handle
- In-line pattern
- 100% free way

DESCRIPTION

The 2-way ball valves, type S4, are designed for industrial and chemical applications with various materials combination. The ball seat made of PTFE allows a long operating time. A secured and lockable handle prevents of any accidental operation. These modular valves, can receive limit switches, or even supporting adapters to mount electric or pneumatic actuator.

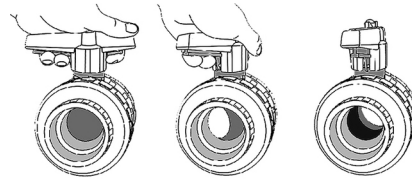
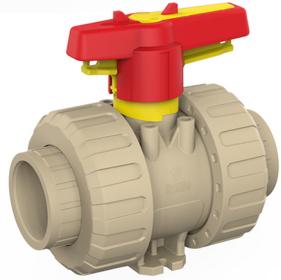
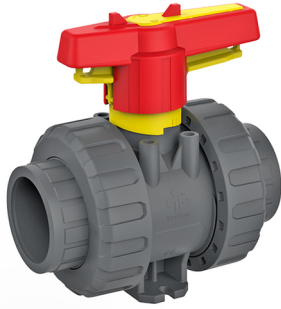

TECHNICAL FEATURES

Body	PVC-U or PP-H or PVDF
Sealing	Seals in EPDM or FPM
Ball	Same material as the body
Ball seat	PTFE
Fittings	Unions (female) PVC, PPH or PVDF Other types or materials on request

Accessories:

- Supporting adapters, 2 models:
- Adapter to mount an electric or pneumatic actuator.
- Adapter for limit switches

EC Conformity: The instrument meets the legal requirements of the current European Directives.

CODE NUMBERS: refereing to NB "nominal bore"

Body	PVC-U		PP-H		PVDF
	EPDM	FPM	EPDM	FPM	FPM
NB 10	AD128809	AD128819	BD124084	BD124140	CD124091
NB 15	AD128810	AD128820	BD124085	BD124141	CD124092
NB 20	AD128811	AD128821	BD124086	BD124142	CD124093
NB 25	AD128812	AD128822	BD124087	BD124143	CD124094
NB 32	AD128813	AD128823	BD124088	BD124144	CD124095
NB 40	AD128814	AD128824	BD124089	BD124145	CD124096
NB 50	AD128815	AD128825	BD124090	BD124146	CD124097
NB 65	AD124227	AD124230	BD124280	BD124283	CD124292
NB 80	AD124228	AD124231	BD124281	BD124284	CD124293
NB 100	AD124229	AD124232	BD124282	BD124285	CD124294

Pressure vs. Temperature

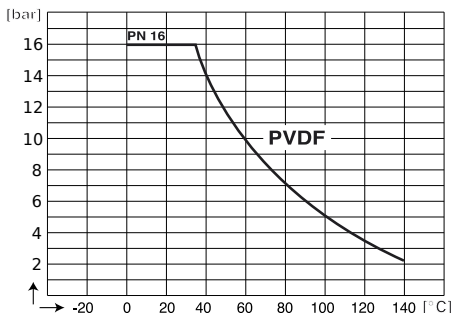
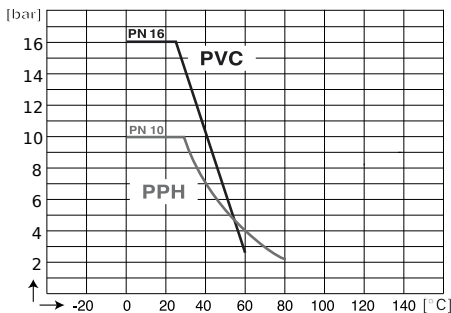

BAMO INTERNATIONAL

22, Rue de la Voie des Bans · Z.I. de la gare · 95100 ARGENTEUIL
 Tel +33 (0)1 30 25 83 20 Web www.bamo.eu
 Fax +33 (0)1 34 10 16 05 E-mail export@bamo.fr

Manually operated 2-way ball
valves, industrial series
VM2V M1

16-10-2019

D-934.04-EN-AD

PLAS

934-04/1

DIMENSIONS [mm]

Body in PVC-U – PN 16

	d	A	B	C	D	E	F	H	t	Z
NB 10	16	45	39.5	33	55.5	5.5	34	70.5	16	51
NB 15	20	45	39.5	33	55.5	5.5	34	70.5	16.55	50
NB 20	25	53.5	51	40	62	5.5	36	77	19.5	59.5
NB 25	32	54	51	43	70	6.5	38	79.5	23	60
NB 32	40	62	63.5	51	84	6.5	40	98	26.5	68.5
NB 40	50	78	72	56	101	6.5	45	105.5	31.5	86
NB 50	63	87	84	64	115	6.5	50	114	38.5	98
NB 65	75	111.5	110	85	149	8.3	65	142	44.5	122
NB 80	90	135.5	132	100	182	10.3	80	153	56.5	152.5
NB 100	110	135.5	132	100	182	10.3	80	153	61	162

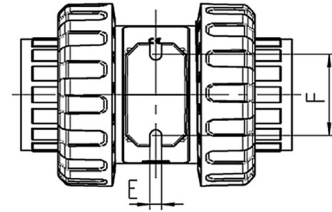

Body in PP-H – PN 10

	d	A	B	C	D	E	F	H	t	Z
NB 10	16	61,5	40	33	58	5,4	34	74,5	14,5	69,5
NB 15	20	61,5	40	33	58	5,4	34	74,5	16	66,5
NB 20	25	69	51,5	40	68,5	5,4	36	83	17,5	78
NB 25	32	73	51,5	43,5	75,5	6,4	38	85,5	19,5	84
NB 32	40	83	64	51	92	6,4	40	104,5	22	97
NB 40	50	94	73	56,5	108	6,4	45	113	25,5	114
NB 50	63	109	85	64,5	127,5	6,4	50	121,5	29	136,5
NB 65	75	131,5	110	85	160	8,3	65	151,5	34,5	162
NB 80	90	156,5	132	100	196,5	10,3	80	167	38,5	206,5
NB 100	110	156,5	132	100	196,5	10,3	80	167	42	207,5

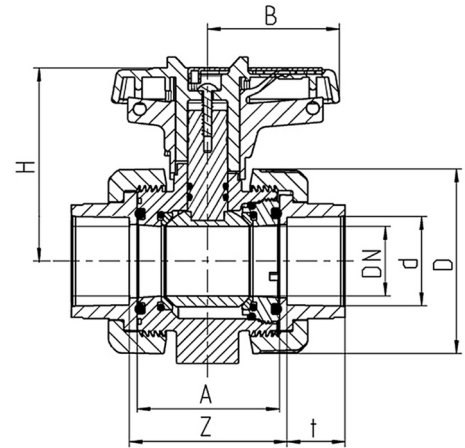

Body in PVDF – PN 16

	d	A	B	C	D	E	F	H	t	Z
NB 10	16	61,5	40	33	56,5	5,4	34	74,5	14,5	69,5
NB 15	20	61,5	40	33	56,5	5,4	34	74,5	16	67
NB 20	25	69	51,5	40	67	5,4	36	83	17	78
NB 25	32	73	51,5	43,5	73,5	6,4	38	85,5	19,5	84
NB 32	40	83	64	51	90	6,4	40	104,5	22	97
NB 40	50	94	73	56,5	105,5	6,4	45	113	25	113
NB 50	63	108,5	85	64,5	124,5	6,4	50	121,5	29	136
NB 65	75	131,5	110	85	157,5	8,3	65	151,5	35	158,5
NB 80	90	156,5	132	100	192,5	10,3	80	167	38,5	205
NB 100	110	156,5	132	100	192,5	10,3	80	167	44	163

Mass [kg]

	NB 10	NB 15	NB 20	NB 25	NB 32	NB 40	NB 50	NB 65	NB 80	NB 100
PVC-U	0.22	0.22	0.33	0.41	0.65	1.03	1.55	3.24	5.44	5.44
PP-H	0.22	0.22	0.33	0.41	0.65	1.03	1.55	3.24	5.44	5.44
PVDF	0.25	0.25	0.38	0.49	0.81	1.22	1.91	3.82	6.43	6.43

BAMO

INTERNATIONAL
 22, Rue de la Voie des Bans · Z.I. de la gare · 95100 ARGENTEUIL
 Tel +33 (0)1 30 25 83 20 Web www.bamo.eu
 Fax +33 (0)1 34 10 16 05 E-mail export@bamo.fr

**Manually operated 2-way ball
 valves, industrial series
 VM2V M1**

16-10-2019

D-934.04-EN-AD

PLAS

934-04/2

PVC-U Valves, specificities

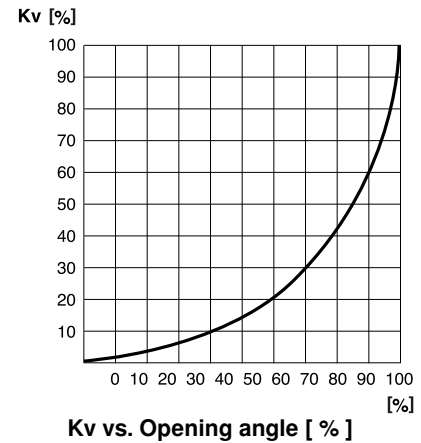
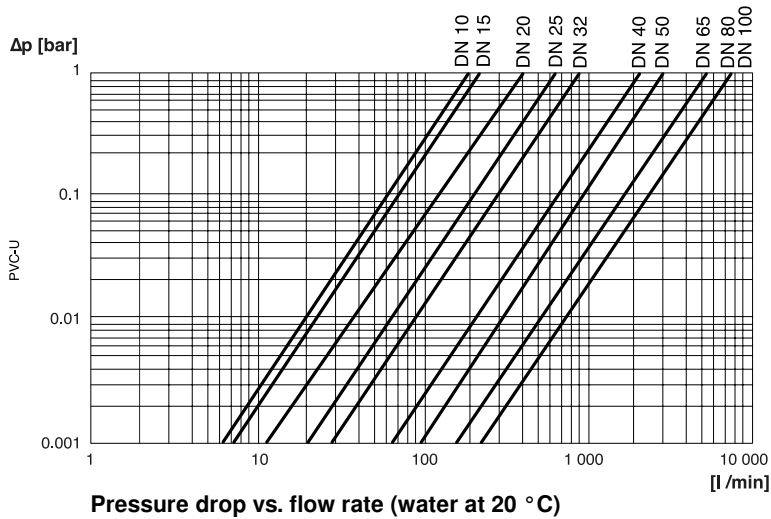

Kv values table (water at 20 °C):

NB	10	15	20	25	32	40	50	65	80	100
d	16	20	25	32	40	50	63	75	90	110
Kv [l/min] at pressure drop 1 bar	198	225	400	630	900	2120	3000	5150	7600	
Kv [l/min] at pressure drop 0.001 bar	6,2	7,1	12,6	19,9	28,4	67	94,8	162,8	240,3	

PP-H and PVDF valves, specificities

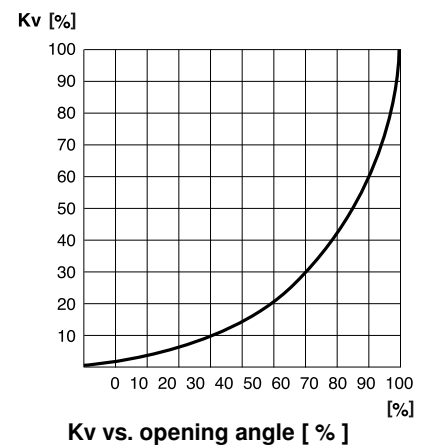
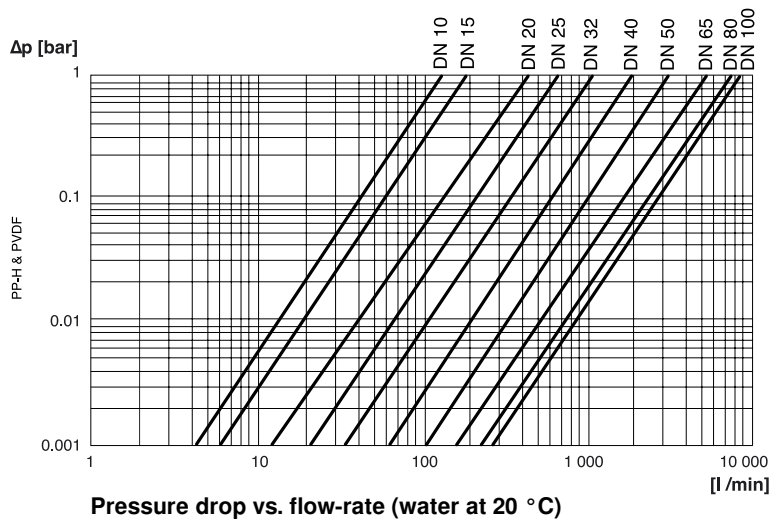

Kv values table (water at 20 °C):

ND	10	15	20	25	32	40	50	65	80	100
d	16	20	25	32	40	50	63	75	90	110
Kv [l/min] at pressure drop 1 bar	130	190	440	650	1080	1980	3240	5200	7500	8850
Kv [l/min] at pressure drop 0.001 bar	4,1	6,0	13,9	20,6	34,2	62,6	102,5	164,4	237,1	279,8

BAMO INTERNATIONAL

22, Rue de la Voie des Bans · Z.I. de la gare · 95100 ARGENTEUIL
 Tel +33 (0)1 30 25 83 20 Web www.bamo.eu
 Fax +33 (0)1 34 10 16 05 E-mail export@bamo.fr

Manually operated 2-way ball valves, industrial series
VM2V M1

16-10-2019

D-934.04-EN-AD

PLAS

934-04/3

ACCESSORIES

Mounting support, double function, for valves M1 series

Description

- 1 accessory, 2 applications: As a blocking support or as a spacer
- Material: PA-G (black; fiber glass reinforced)
- For mounting on valves ND 10 up to ND 50

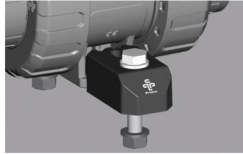

Function: As a Blocking support

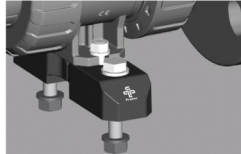

Function: As a spacer

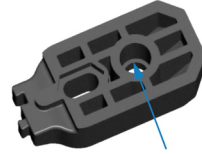

Bore for threaded bushing

NB	10	15	20	25	32	40	50
d	16	20	25	32	40	50	63
T	54			65			
U	25			32			
V	6.5			8.5			
W	16			22			
X	90	94	107	109	114	119	
X1	70			85			
Y	49	56	65	73	78	86	

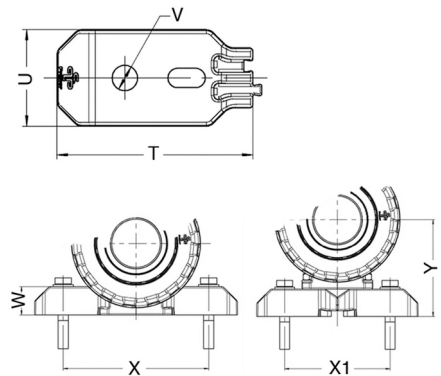

Code numbers

Code	Description
AD141776	Mounting support, double function for valves M1: NB 10, 15 and 20
AD141777	Mounting support, double function for valves M1: NB 25, 32, 40 and 50

Mounting adapters for actuators on M1 series

Description:

- Material: PA-G (fiber glass reinforced)
- Stainless steel screws, included
- For mounting on valves NB 10 up to NB 80
- *More information: on request*

Code numbers:

Code	Description
AD129011	Adaptater for valves M1: NB 10 and 15
AD129012	Adaptater for valves M1: NB 20 and 25
AD129013	Adaptater for valves M1: NB 32
AD129014	Adaptater for valves M1: NB 40 and 50
AD210631	Adaptater for valves M1: NB 65
AD210632	Adaptater for valves M1: NB 80

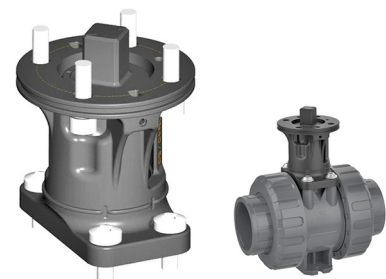

BAMO INTERNATIONAL

22, Rue de la Voie des Bans · Z.I. de la gare · 95100 ARGENTEUIL
 Tel +33 (0)1 30 25 83 20 Web www.bamo.eu
 Fax +33 (0)1 34 10 16 05 E-mail export@bamo.fr

Manually operated 2-way ball
 valves, industrial series
VM2V M1

16-10-2019

D-934.04-EN-AD

PLAS

934-04/4

