

Manually operated 3-way ball valves, industrial series VM3V S4



- Secure and lockable handle
- Radial mounting and dismounting
- 100% full flow

DESCRIPTION

With the different material combinations, the 3-way ball valves VM3V S4 are ideal for industrial and chemical applications. The ball is bored in L or T shape for different handlings of the flow / liquids. The ball seat made of PTFE insures a long service time. A secured and lockable handle prevents of any accidental operation.

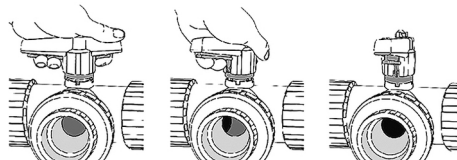

Pressure vs. Temperature

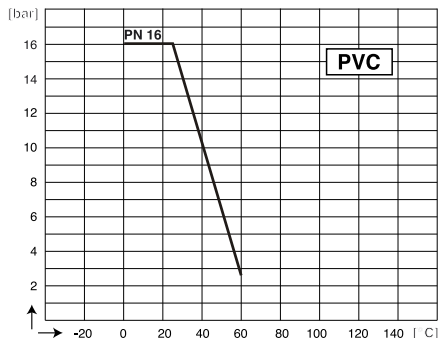

TECHNICAL FEATURES

Body PVC or PPH or PVDF
 Seals EPDM or FPM; On PVDF valves: Only FPM
 Ball T or L bore; Same material as the body
 Ball seat PTFE
 Fittings Unions (socket ends) PVC, PPH or PVDF
 Other types or materials: On request

EC Conformity: The instrument meets the legal requirements of the current European Directives.

CODE NUMBERS AND REFERENCES

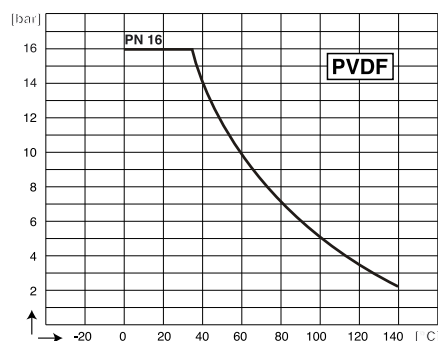
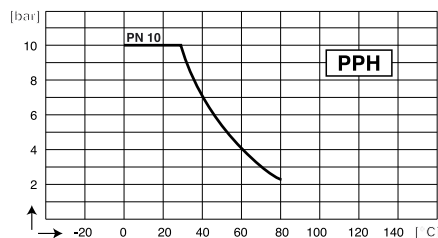

T-bored balls, materials: Body / Seals

ND	PVC / EPDM	PVC / FPM	PPH / EPDM	PPH / FPM	PVDF / FPM
10	AD 120 625	AD 120 667	BD 124 767	BD 124 898	CD 124 918
15	AD 120 627	AD 120 669	BD 124 771	BD 124 902	CD 124 922
20	AD 121 816	AD 121 831	BD 125 014	BD 125 022	CD 125 030
25	AD 121 774	AD 120 307	BD 124 775	BD 124 906	CD 124 926
32	AD 122 714	AD 120 767	BD 125 016	BD 125 204	CD 125 032
40	AD 122 715	AD 120 768	BD 124 890	BD 124 910	CD 124 930
50	AD 122 716	AD 120 769	BD 124 894	BD 124 914	CD 124 934

L bored balls, materials: Body / Seals

ND	PVC / EPDM	PVC / FPM	PPH / EPDM	PPH / FPM	PVDF / FPM
10	AD 120 626	AD 120 668	BD 124 768	BD 124 899	CD 124 919
15	AD 120 628	AD 120 670	BD 124 772	BD 124 903	CD 124 923
20	AD 121 832	AD 121 834	BD 125 015	BD 125 023	CD 125 031
25	AD 121 833	AD 121 835	BD 124 776	BD 124 907	CD 124 927
32	AD 122 717	AD 120 770	BD 125 017	BD 125 025	CD 125 033
40	AD 122 718	AD 120 771	BD 124 891	BD 124 911	CD 124 931
50	AD 122 719	AD 120 772	BD 124 895	BD 124 915	CD 124 935

BAMO INTERNATIONAL

22, Rue de la Voie des Bans · Z.I. de la gare · 95100 ARGENTEUIL
 Tel +33 (0)1 30 25 83 20 Web www.bamo.eu
 Fax +33 (0)1 34 10 16 05 E-mail export@bamo.fr

Manually operated 3-way ball
 valves, industrial series
VM3V S4

20-11-2019

D-935.01-EN-AA

PLAS

935-01 /1

DIMENSIONS [mm]

PVC valves										
DN	d	A	Z	t	D	H	B	Y	C	Mass [kg]
10	16	100	105.5	16.5	53	72	40	52.8	50	0.22
15	20		126	20						
20	25	120	127	22.5	70	81.5	51.5	63	60	0.33
25	32		169	27.5						
32	40	162	171	31.5	101	107.5	73	84.5	81	0.65
40	50		121.5	116.5						
50	63	181	193	38.5	121.5	116.5	85	96.5	90.5	1.55

PPH valves										
DN	d	A	Z	t	D	H	B	Y	C	Mass [kg]
10	16	100	109	14.5	52.5	71.5	40	54.5	50	0.22
15	20		129	17						
20	25	119	130	19.5	69.5	80.5	51.5	65	59.5	0.41
25	32		178	22						
32	40	161	181	25	100	106.5	73	89	80.5	0.65
40	50		120.5	115.5						
50	63	180	206	29	120.5	115.5	85	103	90	1.55

PVDF valves										
DN	d	A	Z	t	D	H	B	Y	C	Mass [kg]
10	16	100	109	14.5	51.8	71.5	40	54.5	50	0.22
15	20		129	17						
20	25	118	130	19.5	68.5	80.5	51.5	65	59.5	0.41
25	32		178	22						
32	40	161	181	25	98	106.5	73	89	80.5	0.65
40	50		120.5	115.5						
50	63	180	206	29	118	115.5	85	103	90	1.55

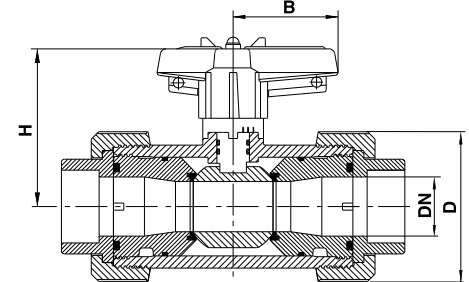
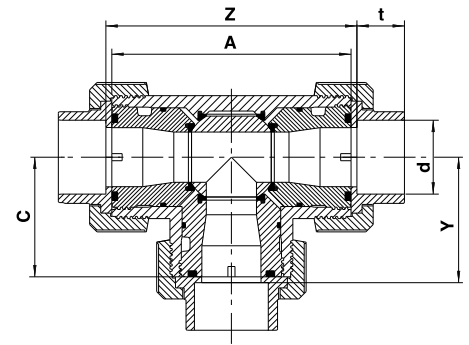

PHYSICAL FEATURES

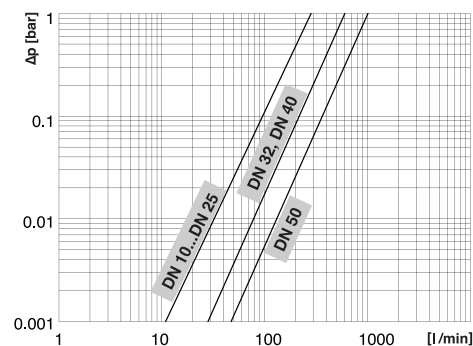
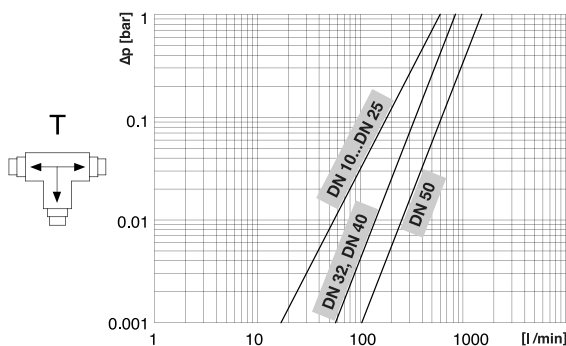
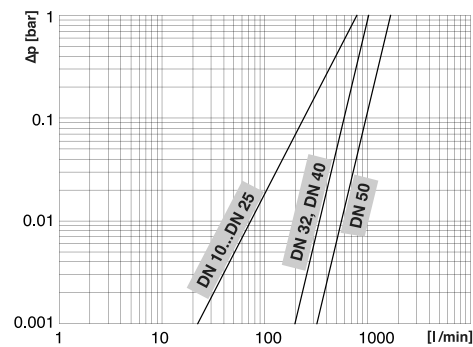
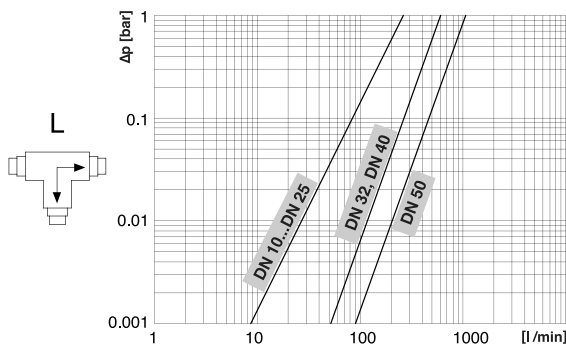

BAMO

INTERNATIONAL
 22, Rue de la Voie des Bans · Z.I. de la gare · 95100 ARGENTEUIL
 Tel +33 (0)1 30 25 83 20 Web www.bamo.eu
 Fax +33 (0)1 34 10 16 05 E-mail export@bamo.fr

Manually operated 3-way ball valves, industrial series
VM3V S4

20-11-2019

D-935.01-EN-AA

PLAS

935-01/2